



L/PV-1

Ball Valves Series L/PV-1

Versions 2-, 3-, 4-, 5-way,
Type 2L/PV-1, 3L/PV-1, 4L/PV-1, 5L/PV-1

Special Features

- Corrosion resistant
- Compact design
- Gas tight
- Maintenance free
- Easy to operate
- Easy mounting
- Controlled position as option

Application

The compact ball valves series L are applicable to shut off gases and liquids. The valves work in a temperature range between -20 °C to +80 °C. The construction of the ball valves is concipated for the analysis technique and especially for the shut-off and switching-over of sample-, test- and reference gases.

The used material guarantees an excellent chemical resistance against flue gases, SO₂, etc.. Please contact us in case of solvents.

Description

The ball valves series L are gastight, maintenance-free and they can easily be handled by means of the big T-handle.

The valves are available as 2-, 3-, 4- and 5-way executions, with the type designation 2L/PV-1, 3L/PV-1, 4L/PV-1 and 5L/PV-1. The ball valves are made of PVDF with a nominal width of 4 mm.

The sealing of the ball is caused by means of adjustable circular shapes and FPM o-rings. The ball valves are equipped with G1/4" female connectors. Corresponding tube- and hose fittings are available in our range of products.
– See data sheet 11.6 / 11.7. –

The ball valves are fixed with a locknut. This provides a simple system mounting and the inlet- and outlet connections can be located as requested.

For control of a fixed position, e.g. when switching over from sample gas to test gas, a micro switch /K including position plate, mounting angles, terminals and complete assembly is available for all ball valve executions. The status alarm is realised by a potential free change over contact.

Dimensions

2-way-ball valve 2L/PV-1

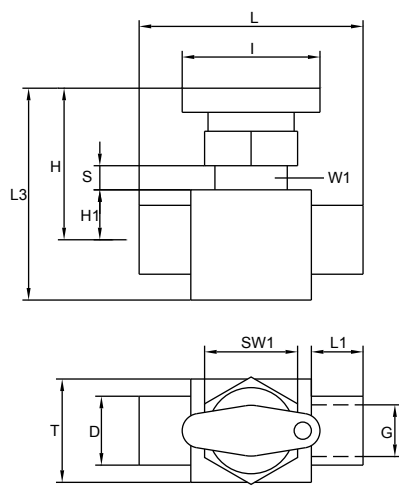

3-way-ball valve 3L/PV-1

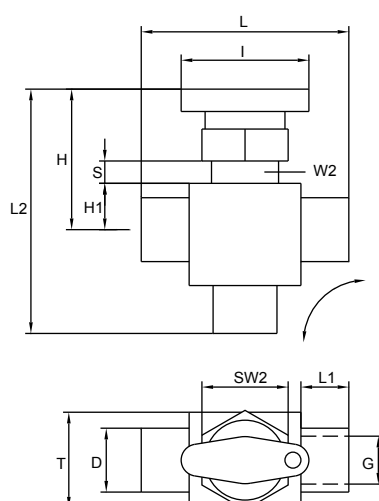

5-way-ball valve 5L/PV-1 with status contact

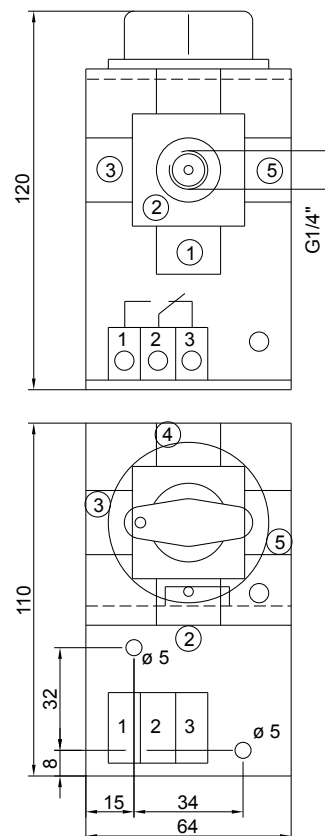

4-way-ball valve 4L/PV-1

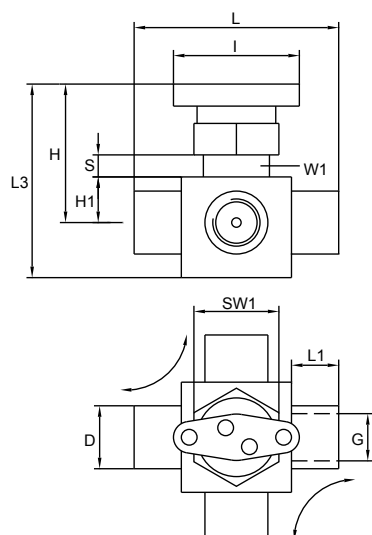

5-way-ball valve 5L/PV-1

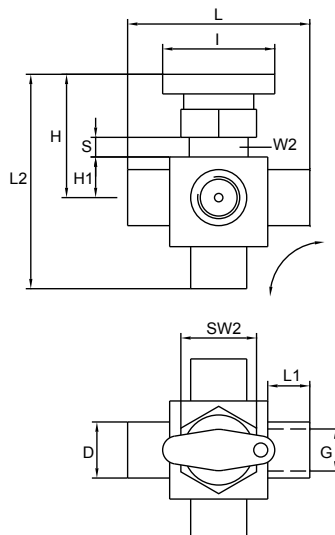

1. Central point/outlet
2. controlled connection, i.e. sample gas
3. i.e. zero gas
4. i.e. calibration gas 1
5. i.e. calibration gas 2

Drilling diagramm

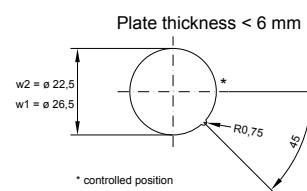

Dimensions in mm

	D	G	H	H1	I	L	L1	L2	L3	S	SW1	SW2	T	W1	W2
2-way	ø 20	G1/4"i	45	12,5	45,8	65			61	max. 6	32		32	26	
3-way	ø 20	G1/4"i	46,7	14	45,8	65	15	79,2		max. 7		27	32		22
4-way	ø 20	G1/4"i	45	12,5	45,8	65			61	max. 6	32			26	
5-way	ø 20	G1/4"i	~49	14	ø 25	65	15	~81,5		max. 7		27			22

Max. operation pressure depending on the operation temperature

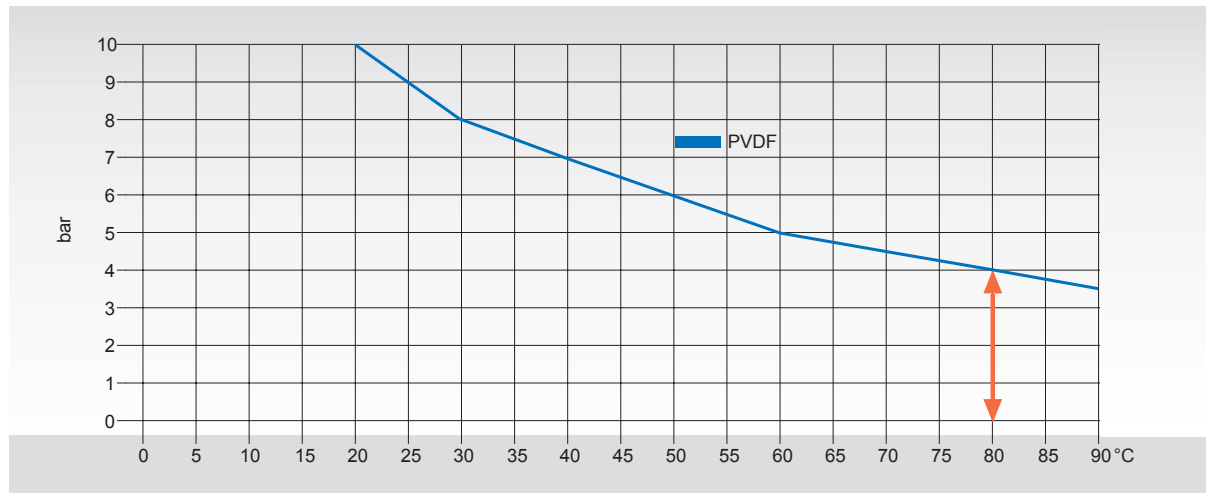

The max. operation pressure decreases with increasing temperature.
The temperature of 20 °C is related to air at 65% humidity (DIN 50014).

Technical Data

Ball valves series L	type 2L/PV1	type 3L/PV1	type 4L/PV1	type 5L/PV1	Contact /K
Part No.	01V3000	01V3050	01V3100	01V3150	01V2005
Ball hole	I-form	L-form vertical	2x L-form	L-form vertical	
Nominal width	NW 4*				
Max. operating pressure at 20 °C	PN10, 10 bar				
Flow coefficient	0,43*				
Operating- and ambient temperature	-20 up to +80 °C*				-10 up to +60 °C
Storage temperature	-30 up to +110 °C				-25 up to +70 °C
Operation	manual				manual
Type of mounting	front plate option for wall mounting: mounting angles as /K, part no: 01V2006 01V2004 01V2006 01V2004				wall mounting
Material of sample contacting parts	PVDF, FPM*				
Connections G1/4" i DIN ISO 228/1*	2x	3x	4x	5x	
Controlled position					1x
Electrical connection					terminals 3 x 4 mm ²
Protection					IP20 EN 60529
Max. contact rating of change over contact					48V, 0,5A, 24W
Weight	0,07 kg	0,08 kg	0,09 kg	0,1 kg	0,14 kg

* Standard version ex stock; other structural shape, material, nominal width or connections upon request.